

CLIENT EXPERIENCE



A groundbreaking benefits solution that returns value to your company.

Free up time to focus on other areas of your business.

Quickly review important benefit activity and information.

Track participation and account activity all within one system.

OVERVIEW

\$14,000.56
ABC Company cash account available balance

2018 BENEFIT PLANS

- ABC Company HSA
Approved enrollment by 8/31/2018
- Transit
Plan started on 06/01/2018
- ABC Company COBRA
Plan started on 01/01/2018
- Dependant Day Care
Plan started on 01/01/2018

CONTRIBUTIONS AND DISBURSEMENTS

2018

- 75% \$2,857,334 Employee contribution
- 89% \$3,562,495 Employer contribution
- 55% \$5,62,495 Disbursements

REIMBURSEMENT

Last week

- 12,504 Total Reimbursements
85% reimbursements done by TASC card
- 5,504 \$11,500 (30%) Reimbursements that require additional verification
- 7,000 \$12,500 (70%) Reimbursements that are auto-verified

ACTIVE USERS

CUSTOMER CONTACTS

RECENT FUNDING TRANSACTIONS

BENEFIT PLANS

Select Plan Start Year: 2018 | Status: [Filter]

Plan Name	Employees	Status	Plan Start Date	
Limited Purpose Medical FSA	46	Active	06/26/2018	
ABC Company HSA	32	Active	05/26/2018	Renew
ABC Limited Purpose Medical FSA-2018	46	Active	06/26/2018	Renew
ABC Company HSA-2018	32	Active	05/26/2018	Auto Renew

Total: 4

MANAGE EMPLOYEES

Search By Name, TASC ID, Class or Keyword

Filter by: Hire Date | Employment Status | Class | Division | Subdivision | Benefit Plans

[Add Employee](#)

Name	TASC ID	Status	Hire Date	Class	Benefit Plans	Recently Added
Austin Perry	1234-9225-2345	Active	07/12/2017	Full Time	Multiple Benefits	07/19/2018
Carol Castro	1234-9225-5413	LOA	07/20/2017	Full Time	Multiple Benefits	05/09/2018
Donald Peters	1234-9225-6396	Term	07/22/2017	Union	Wellness Benefits	04/08/2018
John Hall	1234-9225-4032	Active	08/22/2017	Non Union	Multiple Benefits	04/05/2018
Melissa Tucker	1234-9225-2697	LOA	08/24/2017	Part Time	Multiple Benefits	03/10/2018
Nicholas Fowler	1234-9225-2519	Term	09/26/2017	Union	Continuer Benefits	02/01/2018

ENROLL EMPLOYEES

Enroll Multiple Employees

Enroll multiple employees at once by uploading a completed enrollment file.

[Start](#)

Enroll Single Employee

Enroll one employee at a time by manually entering their information.

[Start](#)

Efficiently enroll and manage employees as needed throughout the year.

Offer your employees a better, more connected benefits experience.

There is only ONE website, ONE mobile app, ONE TASC card for all accounts. When benefits are fast and easy, employees are happier and more productive.

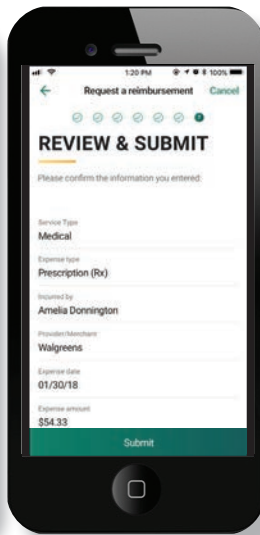
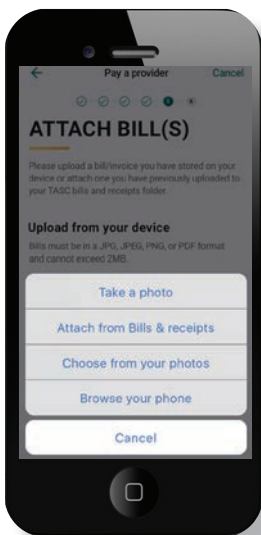
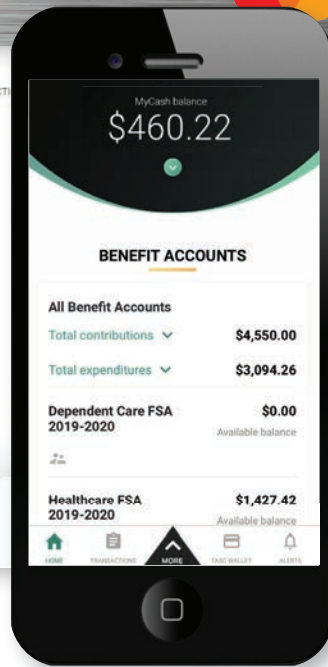
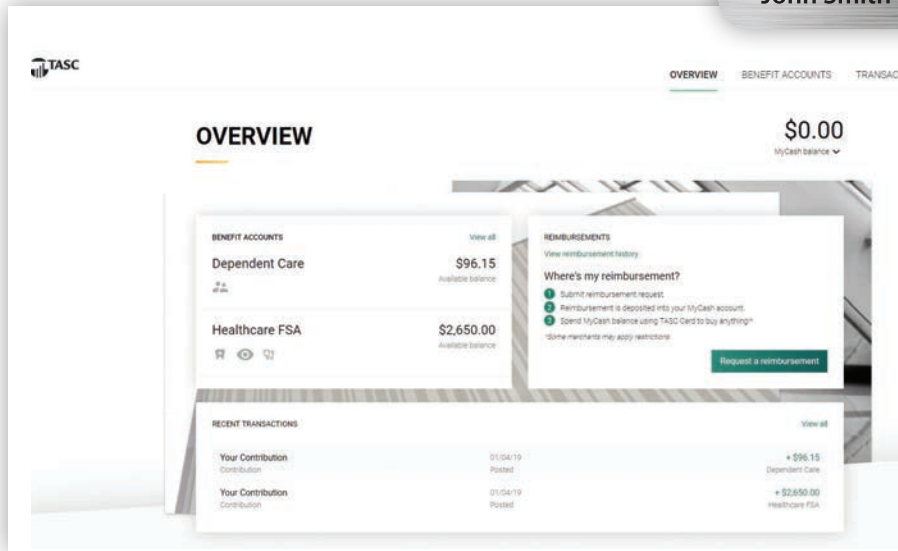

Universal Benefit Account® offers over 50 integrated accounts, so you can offer an unrivaled benefit plan to your employees without adding to your workload.